

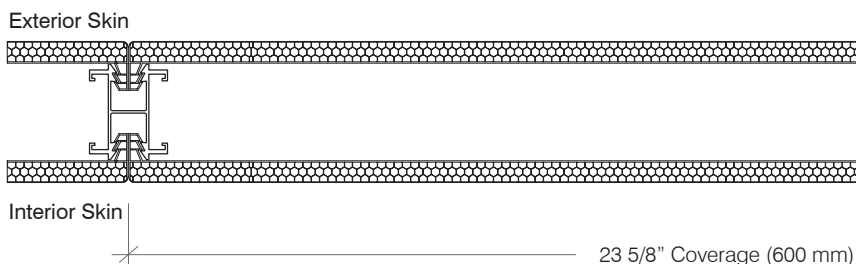

Product Specifications

Thickness:	2.75 in (70 mm) & 4 in (102 mm)
Width:	2 ft nominal (23 5/8 in) (600 mm)
Length:	Up to 44 ft long
Panel Weight:	1.5-2 lbs/ft²
Technology:	Removable Skin Technology (RST) - Allows for the removal of the exterior panel while the interior panel remains in place
Panel Joint:	Structural member, mechanically interlocking, sealed joint
Exterior Skin:	10 mm Pentaglas® translucent panel with Nano-Cell® extrusion
Interior Skin:	8 mm Pentaglas® translucent panel with Nano-Cell® extrusion
Color Options:	Standard - Clear, white, ice white, blue, green, bronze, refl. gray Note: all colors are available with a matte finish upon request - consult for other available color options
Bi-Color System:	Color selected for the exterior skin may be different from the color selected for the interior skin

Flush Look



Panelized with Mullions

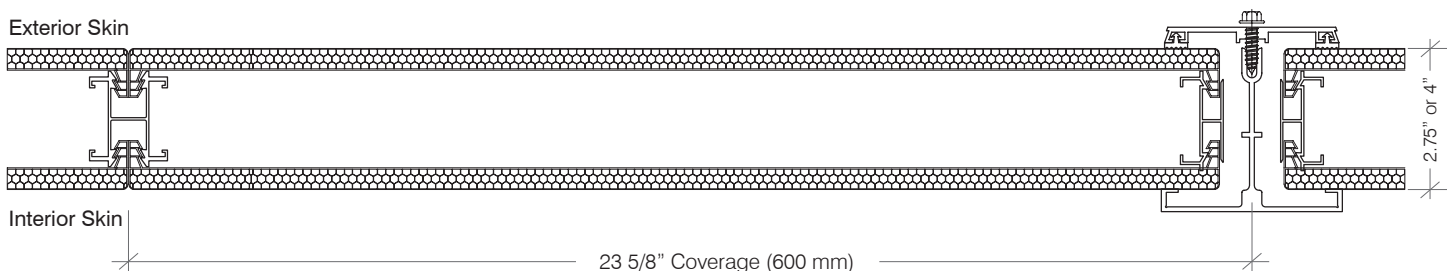



Test Description	Test Procedure	Results & Comments
Code Compliance, IBC	ICC -ES report ESR-1253	Complies as specifically detailed in the ESR-1253 report
Uniform Load Structural / Spans	ASTM E330	*Consult CPI Daylighting for job specific span capabilities
Large Missile Impact	ASTM E1996/E 1886	Pass - Missile Impact Level D, Wind Zone 4
	FBC 2014, TAS 201	Pass - Missile Impact Level D, 350 lbf-ft
High Velocity Hurricane Zone (HVHZ)	TAS 201, 202, 203	FL8804 - 2.75" system approved for design load of +/- 91.5 psf Higher loads or larger spans are available.
		*Consult CPI Daylighting for job specific span capabilities
Concentrated Load 3" Diameter	ASTM E661	No Damage, 400 lbf load
Concentrated Load 1 sqf Area	(OSHA) 29 CFR Section 1910.23(e)(8)	No Damage 600 lbf load
	California Code of Regulation Title 8, Section 1632 (b)(3)	No Damage 600 lbf load
	California Code of Regulation Title 8, Section 3212(b)	No Damage 600 lbf load
Water Penetration	ASTM E331 / AAMA	Pass - 15 psf
Air Infiltration	ASTM E283 / AAMA	Pass requirements per NFRC 400 at 1.57 psf and 6.24 psf
U-Factor	NFRC 100	0.23 to 0.08 center of glass
SHGC	Calorimeter	0.40 to 0.08 subject to color selections
Fire	ASTM E1929, D2843, D635	Approved light transmitting plastic with CC1 Rating
Interior Flame Spread	ASTM E84	Class A Rating
Class A, B, & C Roof Construction	ASTM E108, FM 4470, NFPA 256, UL 790, CAN/ULC-S107	Approved for external fire resistance - Classifications A, B, & C
Sound Transmission Loss - STC	ASTM E90, E413, E1332, E2235	Standard STC rating is 26 Special panels with acoustical inserts are available at STC rating of 27-43

*Spanning capabilities are dependent on project specific design loads, which are determined based on several different factors, including location on the building, height above ground, wind speed, etc.

CPI DAYLIGHTING INC is engaged in continuing research to improve its products. Therefore, the right is reserved to modify or change the data provided in this Technical Summary without notice. This is descriptive literature and does not constitute warranties, expressed or implied. For statement of warranty, contact CPI. The above tests were performed and verified by certified independent third parties. If you have questions on a specific test or product, please contact a CPI Representative. CPI Daylighting Inc. does not assure compliance with any plans or specifications and it remains the responsibility of the customer to confirm compliance of the product with applicable local, state, and national codes and other laws or regulations.